

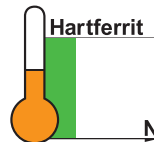

**Flachgreifer, Hartferrit, Edelstahlgehäuse, Bohrung und Senkung**

**Flat pot magnet, hard ferrite, stainless steel body, bore and counter bore**

■ ■ ■ Hergestellt in Deutschland / manufactured in Germany

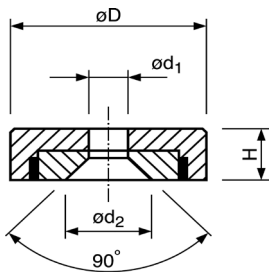

Art.-Nr.	D (mm)	H (mm)	d1 (mm)	d2 (mm)	Haftkraft (N) Power (N)	Gewicht (g) Weight (g)	Temp. (°C) Temp. (°C)
FH020kH	20 ±0,1	6 +0,2/-0,1	4,1 +0,4/-0	9,4 +1/-0	22	9	220
FH025kH	25 ±0,1	7 +0,3/-0,2	5,5 ±0,2	11,5 +1/-0	29	17	220
FH032kH	32 ±0,1	7 +0,3/-0,2	5,5 +0,25/-0,25	11,5 +1/-0	58	27	220
FH040kH	40 +0,2/-0,1	8 +0,4/-0,2	5,5 ±0,2	12,5 +1/-0	72	52	220