

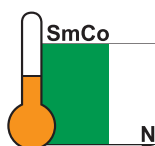

**Flachgreifer, SmCo, Stahlgehäuse, Bohrung und Senkung**  
**Flat pot magnet, SmCo, steel body, bore and counter bore**

■ ■ ■ Hergestellt in Deutschland / manufactured in Germany

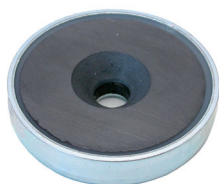
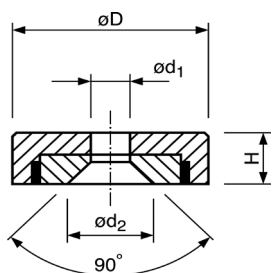

Art.-Nr.	D (mm)	H (mm)	d1 (mm)	d2 (mm)	Haftkraft (N) Power (N)	Gewicht (g) Weight (g)	Temp. (°C) Temp. (°C)
FS016aH	16 ±0,1	4,5 ±0,1	3,5 ±0,1	6,6 +1/-0	57	6	280
FS020aH	20 ±0,1	6 ±0,1	4,5 ±0,1	9,3 +1/-0	81	13	280
FS025aH	25 ±0,1	7 ±0,1	4,5 ±0,1	9,2 +1/-0	105	25	280
FS032aH	32 ±0,1	7 ±0,1	5,5 ±0,1	11,5 +1/-0	235	40	280
FS040aH	40 +0,2/-0,1	8 ±0,1	5,5 ±0,1	11,5 +1/-0	540	75	280